

Health and Hospital Corporation of Marion County

The New Wishard

Diversity Overview Presentation

February 2010



Organization of Building Components



Organization of Building Components

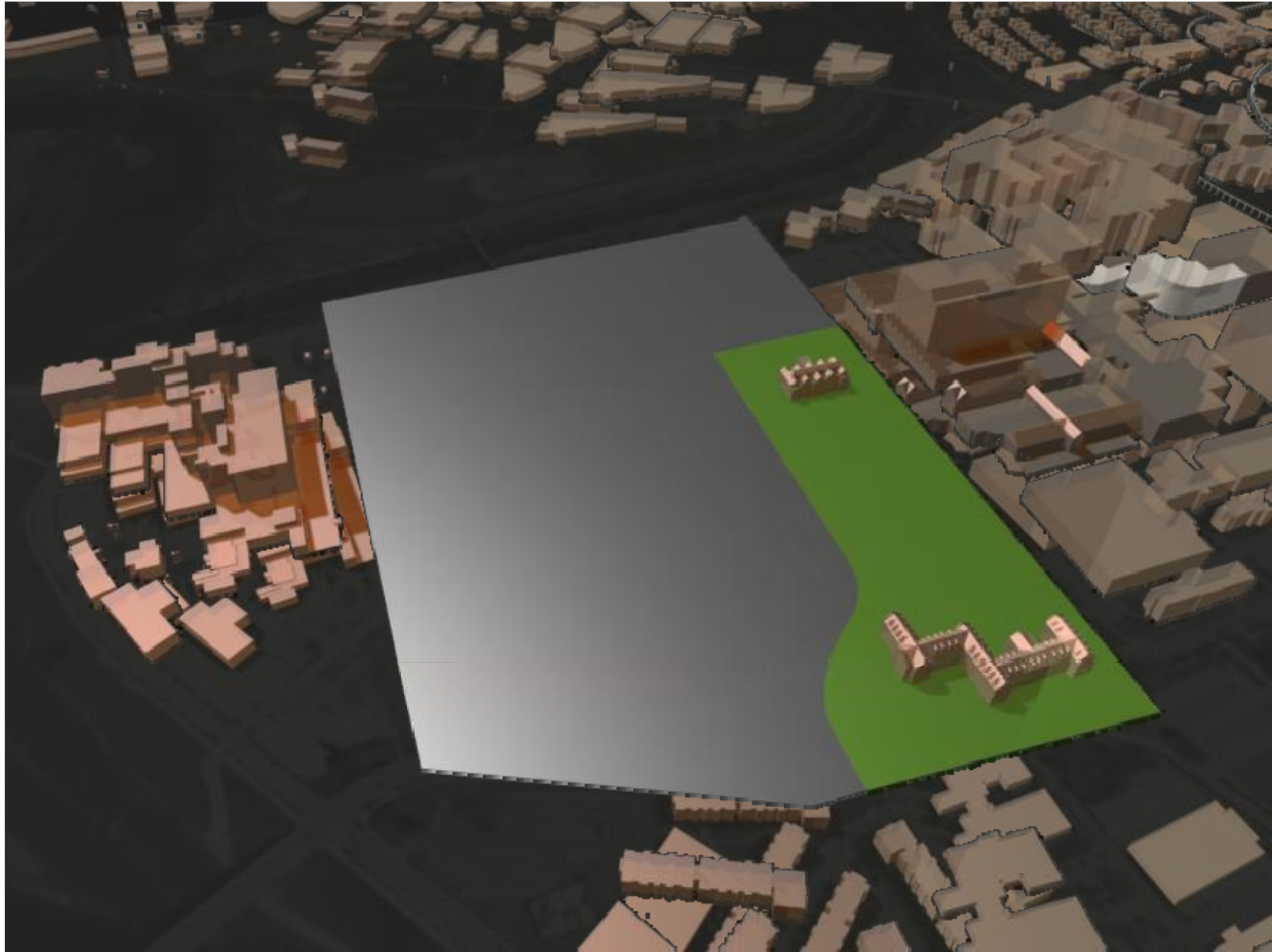

Parking Garage Package



- **Hospital** **825,000 sf**
 - 315 beds
 - Full Diagnostic & Treatment
- **Ambulatory Care Bldg** **175,000 sf**
 - 125 Exam Rooms
- **Administrative Office Bldg** **205,000 sf**
 - Wishard + IU School of Medicine+ Regenstrief Institute + others
- **Central Utility Plant(s)** **40,000 sf**
 - Steam / Chilled water / Emergency Power
- **Parking Garage** **2300 cars**
 - Additionally 1500 +/- on site
- **Over \$600M in total construction budget**

- **Targeting LEED Silver**

- **HOK**
- **A2SO4 Architecture**
- **American Structurepoint**
- **Baigi, Chance, Cummins,
London & Titzer**
- **Blackburn Architects**
- **BSA Lifestructures**
- **Circle Design**
- **Context Landscape
Architecture**
- **Enginuity Mgmt. &
Consulting**
- **Fink Roberts, & Petrie**

- **L'Aquis Consulting Eng.**
- **Mareggatti Interiors**
- **NINebark**
- **Ratio Architects**
- **RLR Associates**
- **Schneider Corporation**
- **Shrewsberry & Assoc.**
- **Synthesis**
- **Syska Hennessey**
- **VS Engineering**
- **Walker Parking
Consultants**

- **Jacobs** – Program Manager

Construction Management Team –

- **Pepper Construction Co. of Indiana**
- **Garcia Construction Group**
- **GDH**
- **Keystone Construction**
- **Shiel Sexton Co., Inc.**
- **Smoot Construction**

Wishard's goals are consistent with the City's goals for the entire project:

- **15% Minority Business Enterprises**
- **8% Women Business Enterprises**
- **3% Veteran Businesses**

Will adjust goals to maximize participation by bid package!

Definitions

- **Minority Business Enterprises – at least 51% ownership by minority interest**
- **Women Business Enterprises – at least 51% ownership by women interest**
- **Veteran Businesses – registered with the U.S Dept. of Veterans Affairs**

Certification by the City of Indianapolis

Availability/Capability

- **Take steps to understand availability & capability of M/W/VBEs**
- **Adjust goals of bid packages to align**

Contracting Opportunities

- **Developing packaging strategies**
- **Calendar of implementation**

Contract Compliance – Basis of Determination

- **Joint Venture – credited with M/W/VBE participation on the basis of percentage of the dollar amount of the work to be performed by the M/W/VBE**
- **M/W/VBE Bidder – will be credited with minority participation for the portion of the contract it performs, and that portion subcontracted to minority firms**
- **M/W/VBE Supplier – Bidder will receive 60 percent toward goal attainment for the use of minority suppliers who are not manufacturers**

Verified with apparent low bidder & at contracting

Contract Compliance –

“Good Faith Effort”

- **To be considered responsive bidder must have demonstrated goals are met**
- **If not met, documented good faith effort required**
- **Team will assist bidders in identification of M/W/VBEs**

Contract Compliance – Documentation Required

Each solicitation for which a contract goal has been established requires the offeror to submit the following information with the bid/proposal:

- The names and addresses of M/W/VBE firms that will participate in the contract;**
- A description of the work that each M/W/VBE will perform;**
- The dollar amount of the participation of each M/W/VBE firm;**
- Written and signed documentation of commitment to use a M/W/VBE subcontractor whose participation it submits to meet a contract goal;**
- Written and signed confirmation from the contracted M/W/VBE as provided in the prime contractors commitment**

Contract Compliance – Non-Compliance Response

- **The participation percentage commitment made upon contract award is deemed to be contractual in nature.**
- **Failure of the Contractor to meet the participation percentage commitment may constitute a material breach of the contract.**
- **HHC as Wishard shall have the right to:**
 - terminate the contract,
 - deduct from money due or to become due the Contractor an amount equal to the dollar amount of the unmet M/W/VBE participation commitment,
 - secure a refund from the Contractor of that amount,
 - or pursue other such remedies at law or in equity to which Wishard may be entitled.

Performance Assurance and Reporting

- Track and monitor
- Report to Advisory Committee (and others)
- Maintain transparency

Plan intent is to be a document that will be revised and edited through addenda

Concept Building Massing

